

# MULTISTAGE PUMPS

Stainless Steel - Electric Motor

## VHSE 8 3-40



Model	Ref.	Power (HP)	Phases	Voltage (v)	Current (Amps)	Stages	H max. (mca) *	Q max. (GPM) **	Suction	Discharge	Weight (Kg)
VHSE 8 3-40	E0778	4.0	3	230/460	11.1	3	78	70	1-1/2"	1-1/2"	28.0

\* The maximum head (H) is achieved with the valve fully closed. (mca = meters column of water).

\*\* Maximum flow (Q) is achieved with valve fully open. (gpm = gallons per minute).



Materials	
Output Case	Stainless Steel 304
Inlet Case	Stainless Steel 304
Impeller	Stainless Steel 304
Volute	Stainless Steel 304
Mechanical Seal	Ceramic / Carbon / Buna-N.

Pump features	
Pump type	Centrifugal
Coupling type	Close coupled
Suction	1-1/2" NPT
Discharge	1-1/2" NPT
Impeller type	Closed <small>Dynamically Balanced SO G6,3</small>
Stage	3
Seal type	Mechanical seal
Fluid Temp	158° F (70° C) Continuous

Applications
- Clean water supply
- Recirculation of water in cooling towers
- Machinery cooling / recirculation circuits
- Filling tank and drinkers
- Drip irrigation
- Booster System

Motor Features	
Motor Type	Electric
Power	4.0 Hp
Speed	3.450 RPM (nominal)
Isolation	Class F
Voltage	220/440v
Service factor	1,0
Frequency	60Hz
Phases	3

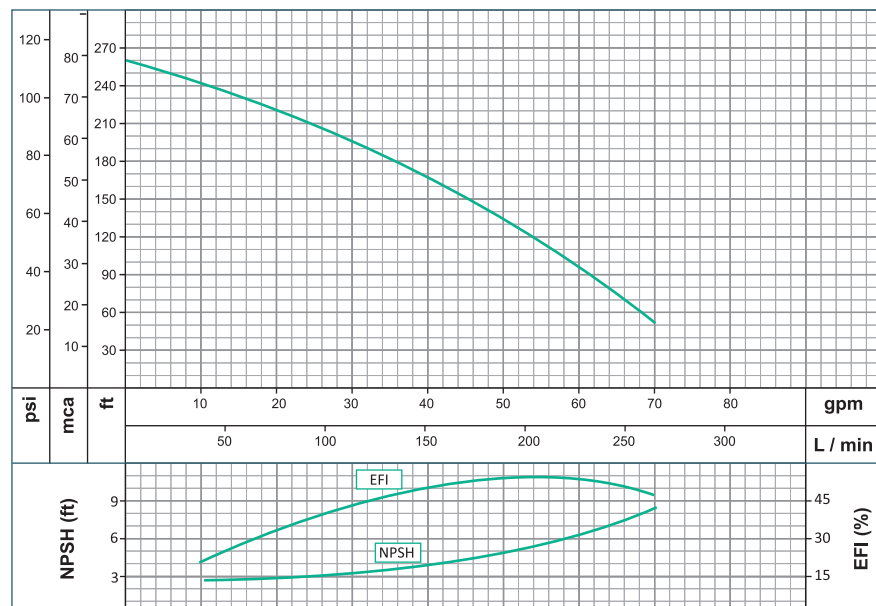

Follow us



[www.wdmpumps.com](http://www.wdmpumps.com)

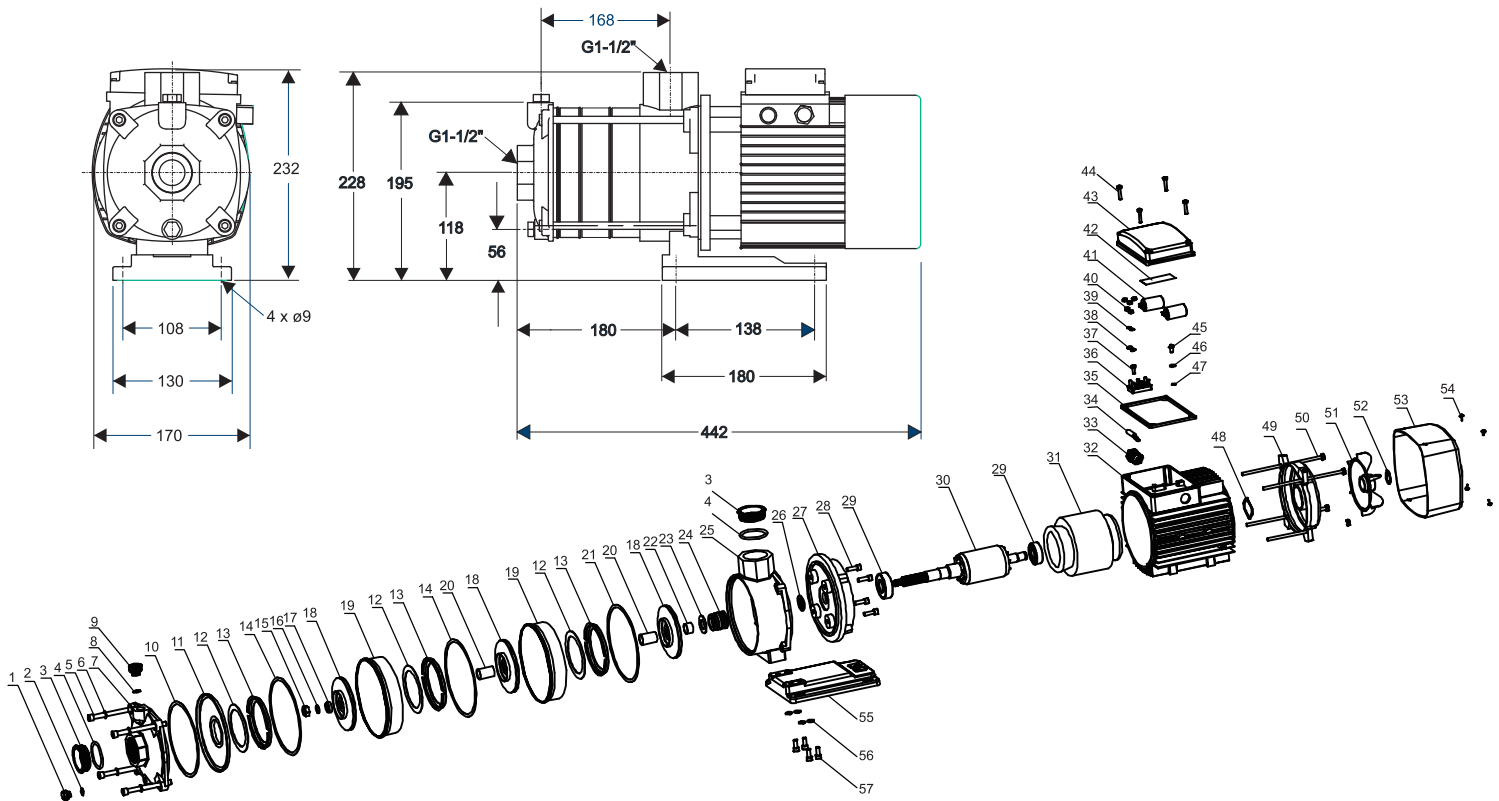

Item	Part No.	Description	Qty	Item	Part No.	Description	Qty
1	CM8-30-1	DRAIN PLUG	1	30	CM8-30-30	ROTOR	1
2	CM8-30-2	O-RING Ø9,2X2,4	1	31	CM8-30-31	STATOR	1
3	CM8-30-3	PLASTIC CAP 1-1/2"	2	32	CM8-30-32	MOTOR CASE	1
4	CM8-30-4	O-RING Ø46X3,5	2	33	CM8-30-33	CABLE OUTLET FITTING	1
5	CM8-30-5	TORNILLO SOCKET M8x130 G5 ZINC	4	34	CM8-30-34	CABLE	1
6	CM8-30-6	PRESSURE WASHER Ø8	4	35	CM8-30-35	TERMINAL PACKAGING	1
7	CM8-30-7	INLET CASE	1	36	CM8-30-36	CONNECTION TERMINAL	1
8	CM8-30-8	O-RING Ø15X2,4	1	37	CM8-30-37	PHILLIPS SCREW M4x10	1
9	CM8-30-9	PRIMING PLUG G3/8	1	38	CM8-30-38	SERVED WASHER Ø4	2
10	CM8-30-10	GASKET FLAT INLET COVER Ø143	1	39	CM8-30-39	FLAT WASHER Ø4 ZINC	2
11	CM8-30-11	VOLUTES INLET COVER	1	40	CM8-30-40	ZINC PLATED M4 HEX NUT	5
12	CM8-30-12	OUTER RING TEFLON GASKET	3	41	CM8-30-41	CAPACITOR 25uF/450V	2
13	CM8-30-13	OUTER RING FOR IMPELLER	3	42	CM8-30-42	CONNECTION DIAGRAM	1
14	CM8-30-14	FLAT GASKET Ø147	2	43	CM8-30-43	TERMINAL COVER	1
15	CM8-30-15	NUT M10	1	44	CM8-30-44	PHILLIPS SCREW M4x25	4
16	CM8-30-16	LOCK WASHER Ø10	1	45	CM8-30-45	PHILLIPS SCREW M5x10	2
17	CM8-30-17	IMPELLER FIXING RING	2	46	CM8-30-46	PRESSURE WASHER Ø5	2
18	CM8-30-18	IMPELLER CM8-30	3	47	CM8-30-47	FLAT WASHER Ø5 ZINC	2
19	CM8-30-19	VOLUTE	2	48	CM8-30-48	WAVY WASHER	1
20	CM8-30-20	LONG SHIRT L=28,5	1	49	CM8-30-49	REAR MOTOR SHIELD	1
21	CM8-30-21	FLAT GASKET Ø145	1	50	CM8-30-50	HEX SCREW M5x180	4
22	CM8-30-22	SHORT SHIRT L=9,5	1	51	CM8-30-51	FAN	1
23	CM8-30-23	WASHER Ø30x17,5x1,5	1	52	CM8-30-52	FAN FIXING RING	1
24	CM8-30-24	MECHANICAL SEAL	1	53	CM8-30-53	FAN COVER	1
25	CM8-30-25	OUTPUT CASE	1	54	CM8-30-54	PHILLIPS SCREW WITH WASHER M4x8	4
26	CM8-30-26	DEFLECTOR	1	55	CM8-30-55	BASE	1
27	CM8-30-27	MOTOR-PUMP COUPLING	1	56	CM8-30-56	PRESSURE WASHER Ø6 ZINC PLATED	4
28	CM8-30-28	HEX SCREW M6x18 G5 ZINC	4	57	CM8-30-57	HEX SCREW M6x16 ZINC PLATED	4
29	CM8-30-29	BALL BEARING 6205	2				